

Wireless Detector Adapter Base (RF-700)



A *Wireless Detector Adapter Base* (RF-700) accepts a compatible fire detector to allow wireless fire detection in a Vigilon system. Compatible fire detector heads are:

- 803271 - Heat detector (temperature rate of rise)
- 803371 - Optical Smoke detector
- 803374 - Dual Optical Smoke Heat detector
- 802177 - Heat detector (high temperature)
- 802473 - Optical Heat CO detector

Compatibility

A wireless device also referred to as *plexus device* and it works with a Loop Radio Transceiver (LRT) that is connected to a Vigilon device loop. The Vigilon panel that controls the loop must have:

- MCC ≥ V4.45 and LPC ≥ V4.43
- ≥ - means equal to or greater than

Batteries

This *plexus device* must only be operated with the approved and recommended batteries Part No. 805597 - SAFT Batteries LS14500 (pack of 4). The lifetime of the batteries is dependent on the device type, the ambient operating temperature and other area environmental conditions. The batteries can be stored up to a maximum of 3 years from the date of manufacture.

Technical Data

Designed to meet standard	EN54-25:2008
Battery	SAFT 4 x 3.6V Lithium batteries - LS14500
Frequency band	868MHz SRD (14 channels)
Range	Up to 100m
Dimensions in mm	135 diameter x 88 depth
Colour	White RAL9010
Weight	178g excludes batteries & detector 16g per battery - (4 required) 110g - detector
Enclosure material	ABS - VO rated
Storage temperature base w/o batteries	-20°C to +65°C
batteries	-20°C to +30°C
Ambient operating temperature	-20°C to +65°C
Relative Humidity	up to 95% - non condensing
Ingress Protection	IP42
Devices per LRT	up to 31 (excludes the LRT)

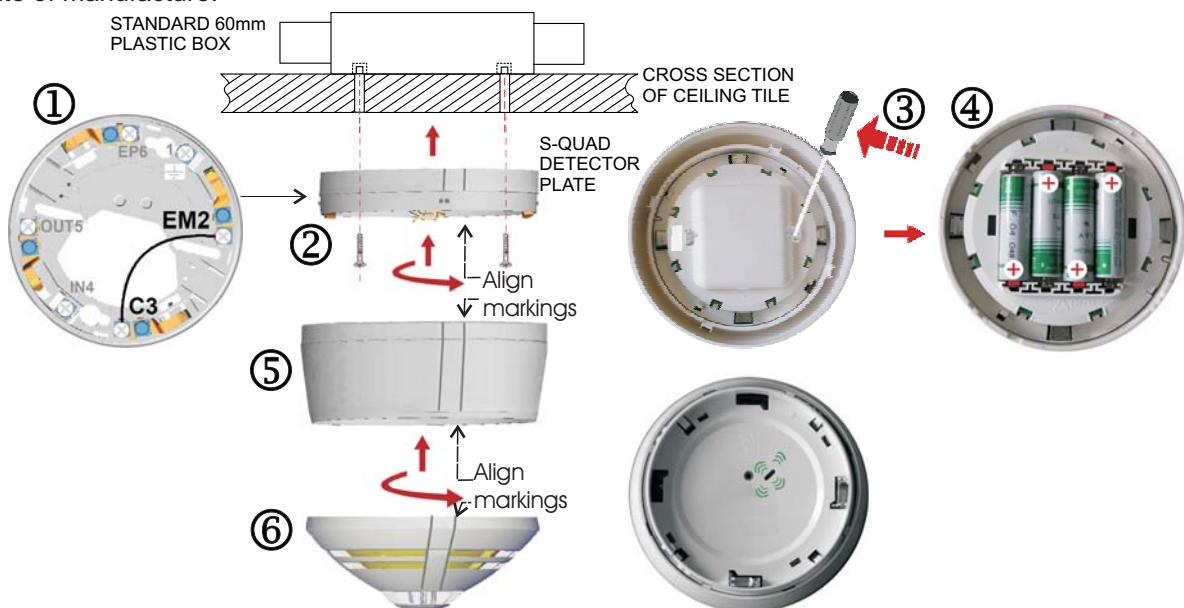

Installation

Do's

- DO install the wireless detectors in locations as recommended in BS5839 Part 1
- DO ensure a Site Survey has been carried out and the 'as fitted drawings' show the exact installation locations of the *plexus* devices
- DO use the detector plate screw fixing points provided to secure it to ceiling.

Don'ts

- DO NOT use adhesive to fix the 'S-Quad Detector plate' to ceiling
- DO NOT install *plexus* devices to include LRTs within 0.3m distance from each other
- DO NOT mix old and new batteries during replacement. Always replace the entire battery set.

- a) Ensure the terminals EM2 and C3 in each 'S-Quad detector plate' are wired together ①.
- b) Fix the 'S-Quad detector plate' to ceiling using suitable screw fixings ②.
- c) Fit the required fire detector ⑥ into a *Wireless Detector Adapter Base* ⑤.

Commissioning

A *plexus* device is programmed to work with a LRT wired to a Vigilon device loop. The programming is done using the Plexus tool and Vigilon Commissioning tool.

- Connect the LRT to a device loop and power up
- Retrieve the factory settings from LRT using the Plexus tool and pre allocate the LRT
- One at a time power up the *Plexus* devices associated with the LRT
- Pre allocate each *Plexus* device with the Plexus tool to work with the associated LRT.

How to power up a wireless detector

 **There is a risk of an explosion if the battery contacts are shorted or if replacement batteries are of incorrect type.**

- a) Open the battery compartment on the *Wireless Detector Adapter Base* ③ and insert the 4 batteries (Part No. 805597) in their correct orientations ④ and then close the battery cover.

- b) Align and insert the *Wireless Detector Adapter Base with a Fire detector fitted* ⑤ into the 'S-Quad detector plate' and turn it clockwise until a click is heard and it locks into place. The unit is now powered up for pre-allocation.

 **Use the detector extractor tool (Part No. S4-EXTRACTOR) and pole to remove the Fire detector and *Wireless Detector Adapter Base*. Refitting is in the reverse order.**

Removal of Detector only



Removal of Wireless Detector Adapter Base with Detector



Maintenance

The remaining capacity of the batteries is checked automatically and a fault is displayed on the panel when the batteries need to be replaced. The batteries must be replaced within 14 days of the fault message.

 **Disposal of the used batteries must be in accordance with recommendations of the battery manufacturer and local regulations.**

CE
0359
Gent by Honeywell
Hamilton Industrial Park,
140 Waterside Road,
Leicester LE5 1TN, UK

Product No. RF-700	EC Certification of Conformity No. 0359-CPD-0132
------------------------------	--

 **At the end of their useful life, the packaging, product and batteries should be disposed of via a suitable recycling centre and in accordance with national or local legislation.**

 **WEEE Directive:**
At the end of their useful life, the packaging, product and batteries should be disposed of via a suitable recycling centre. Do not dispose of with your normal household waste. Do not burn.

Gent by Honeywell reserves the right to revise this publication from time to time and make changes to the content hereof without obligation to notify any person of such revisions of changes.

GENT by Honeywell	Hamilton Industrial Park, Waterside Road, Leicester LE5 1TN, UK		Website: www.gent.co.uk
	Telephone +44 (0) 116 246 2000	Technical support: www.gentexpert.co.uk	Fax (UK): +44 (0)116 246 2300