

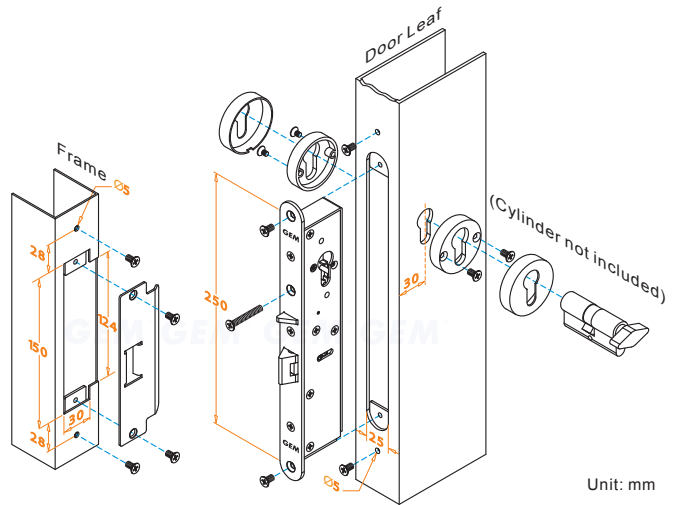

Dimension



Features

- Dual voltage 12 or 24 VDC (selectable)
- Version Changeable
- Automatically and manually
- Long life solenoids
- Lock bolt sensor switch output
- For double swing door (ML-300-2)

Specifications

Power Input	12/24V DC
Voltage Tolerance	±10%
Current Draw	280mA@12 VDC; 140mA@24 VDC
Version Changeable	Fail-safe/secure changeable
Operating Temperature	-10~45°C
Humidity	0~95% non-condensing
Lock bolt sensor switch output	SPDT rated 3A@125VAC
Solenoids testing	Tested to 1,000,000 cycles
Backset	30 mm
Weight	380 g

Patents

M 338884(Taiwan)

Dual voltage selectable

For the 12 VDC operation, the electric strikes have to connect in Parallel.

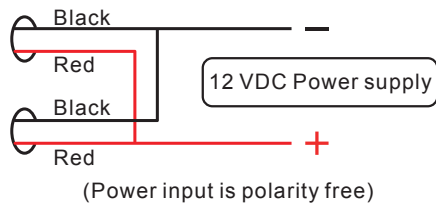

For the 24 VDC operation, the electric strikes have to connect in series.

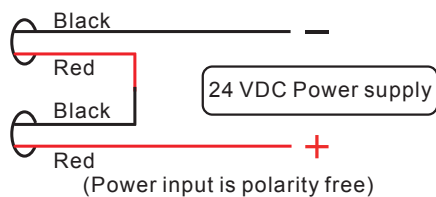

Version Changeable

The Electromechanical Lock is easy changeable between fail-safe and fail-secure in the field. This unique design can help our distributors to reduce the inventory and sales pressure and to meet varying needs and requirements.

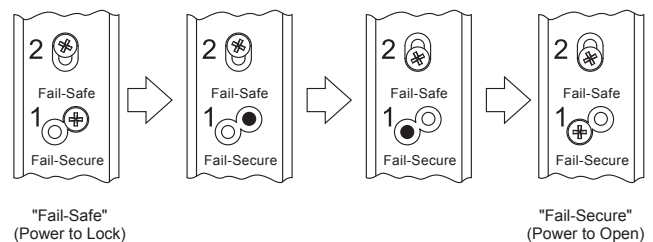

For double swing door

Electromechanical Lock has a special lock bolt. When the door is closed, the lock bolt will automatically deadlocks which it provides enhanced security and greater convenience.

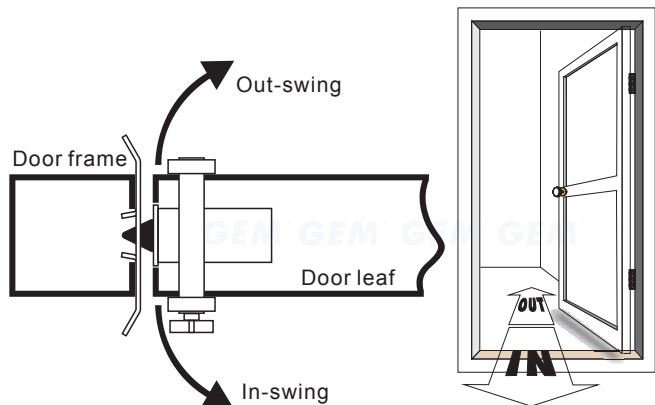

NIB Changeable

Single action door or double action door changeable by a NIB. We also provide optional spare NIB for "Double swing door" in case necessary.

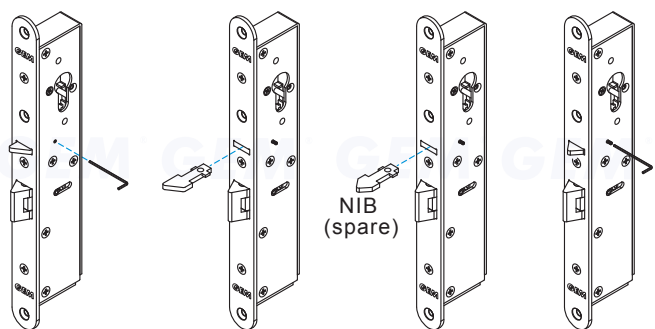

Automatically and manually

The electromechanical Lock can be used automatically and manually. If the access control system is not be opened for the reasons of that the proximity reader is out of order or that unexpected accident happens, the user have the alternative of using the key cylinder.

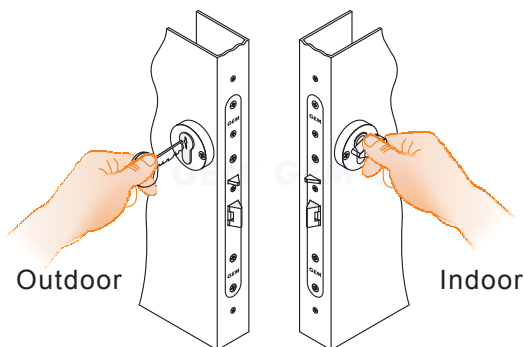

Long life solenoids

Special solenoid designed for strength and long life and is guaranteed the operating lifetime of at least 1,000,000 times.

Breakthrough in innovation ideas

Unobtrusive and slim design can be flush mounted directly into metal such as door mullions. The electromechanical Lock is very lightweight, 25 mm wider faceplate is designed for installation in virtually all types of doors and frames. The rectangular-shaped and arc-shaped faceplate is used to suit the different users' habits of installations.

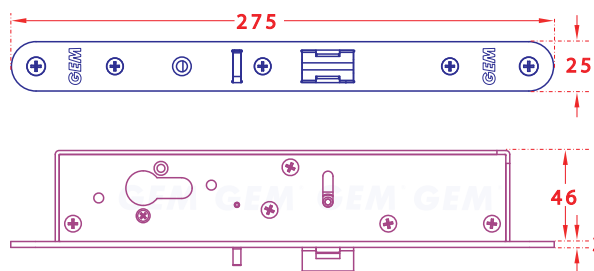

Unit: mm

Lock bolt sensor switch output

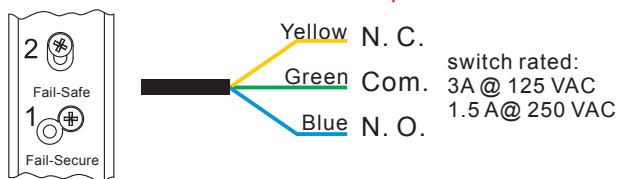

switch rated:
3A @ 125 VAC
1.5 A @ 250 VAC

"Fail-Safe"
(Power to Lock)

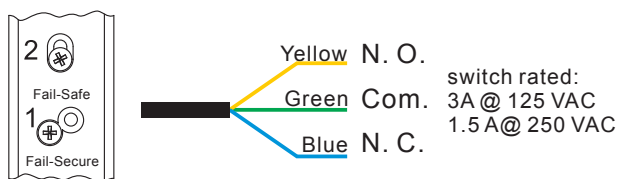

switch rated:
3A @ 125 VAC
1.5 A @ 250 VAC

"Fail-Secure"
(Power to Open)

Warranty

The product is warranted against defects in material and workmanship while used in normal service for a period of 1 year from the date of sale to the original customer. The GEM policy is one of continual development and improvement; therefore GEM reserves the right to change specifications without notice.