

# MK –1000 Series

Magnetic Contacts

**VANDERBILT**



The new EN50131-2-6 approved magnetic contacts series MK-1000 offers selected products with the following features:

- Connection via screw terminals
- Discreet and varied installation
- Constant sensitivity over a wide temperature range
- High reliability guaranteed by reed switch

# MK – 1000 Series

Magnetic Datasheet

VANDERBILT

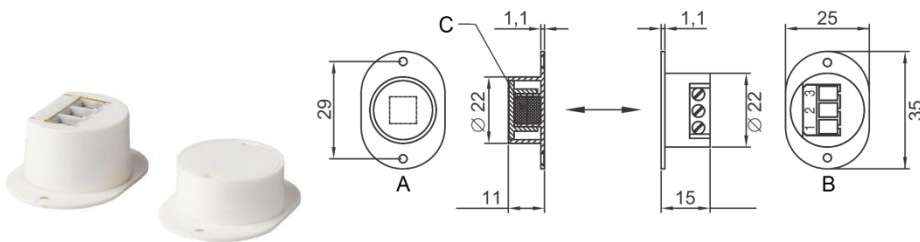

## ■ Technical Data

Connection	3-pole screw terminal
Line contact	Single-pole NC contact
Power input	≤ 40 V DC
Switching current	≤ 500mA
Contact capacity	≤ 6 W
Transition resistance	≤ 0.15 Ohm
Disruptive voltage	> 250 V
Contact dimension	Ø22; 35 x 25 x 15 mm
Magnet dimension	Ø22; 35 x 25 x 11 mm
Temperature range	-25 °C bis +70 °C
Housing material	PA
Magnet material	Neodym Ø8 x 8 mm
Housing protection	IP43
Environmental class EN	II
Approvals	EN, SBSC

VANDERBILT

# MODEL NUMBER

Magnetic Contacts

**VANDERBILT**

## ■ Ordering Information

Type	Order No.	Description	Weight
MK-1400	V54536-F101-A100	Magnetic contact	0.023 kg

**VANDERBILT**