

## EXD SOUNDER BEACON

The EXD Sounder Beacon range has been approved for use in potentially explosive atmospheres and very harsh environmental conditions.

The unit incorporates a four stage alarm option with sixty three tones to choose from which includes four tones that can be recorded or customised by the installer.

All tones can be pre-set during installation. In addition, the unit also incorporates a visual warning signal with a choice of two types of light source: either xenon (strobe) with multiple flash rates and power ratings or an LED array with three status type indication options.

The units also have the ability to be fitted with a telephone initiation function and can be used as the second ring output indicator for telephones when installed in very noisy environments.

The design allows for termination inside the enclosure. The unit can be bracket mounted only.

### Features

- Approved by ATEX and CQST • IMETRO and IECEx (Pending)
- ATEX: II 2G Exd IIC T4 - T6 (Incorporating IIA & IIB)
- Zones 1&2, Zones 21&22 (Pending)
- Conforms to EN (IEC) 60079-0 EN (IEC) 60079-1 and EN54
- 360 degree light output around the vertical axis
- Volume control
- Dustproof & Weatherproof

### Applications

Oil and Gas, On-shore and Offshore, Chemical, Petrochemical, Refineries & Marine locations etc.

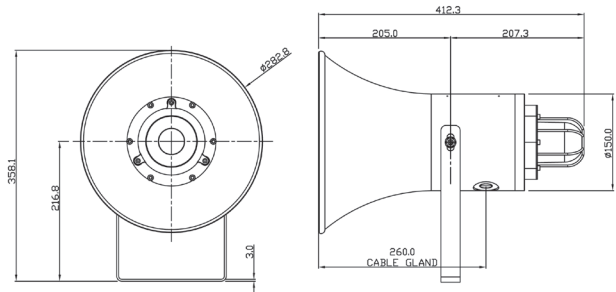

### Approvals & Conformities



### Specifications

Part No.	Voltage (50/60Hz)	Beacon Type	Selectable Tones	Sound Output at 1m	Lens Colour
TCB-0019	12-48 VDC	5J Xenon	63	Up to 115 dB	Amber Lens
TCB-0020	100-240 VAC	5J Xenon	63	Up to 115 dB	Amber Lens
TCB-0021	12-48 VDC	5J Xenon	63	Up to 115 dB	Red Lens
TCB-0022	100-240 VAC	5J Xenon	63	Up to 115 dB	Red Lens
TCB-0023	12-48 VDC	10J Xenon	63	Up to 115 dB	Amber Lens
TCB-0024	100-240 VAC	10J Xenon	63	Up to 115 dB	Amber Lens
TCB-0025	12-48 VDC	10J Xenon	63	Up to 115 dB	Red Lens
TCB-0026	100-240 VAC	10J Xenon	63	Up to 115 dB	Red Lens
TCB-0027	12-48 VDC	20J Xenon	63	Up to 115 dB	Amber Lens
TCB-0028	100-240 VAC	20J Xenon	63	Up to 115 dB	Amber Lens
TCB-0029	12-48 VDC	20J Xenon	63	Up to 115 dB	Red Lens
TCB-0030	100-240 VAC	20J Xenon	63	Up to 115 dB	Red Lens
TCB-0031	12-48 VDC	5W LED	63	Up to 115 dB	Amber Lens
TCB-0032	100-240 VAC	10W LED	63	Up to 115 dB	Amber Lens
TCB-0033	12-48 VDC	5W LED	63	Up to 115 dB	Red Lens
TCB-0034	100-240 VAC	10W LED	63	Up to 115 dB	Red Lens

IP Rating: IP66/67 Operating Temp: -40°C to +70°C

Construction: Glass Reinforced Plastic

Cable Entries: 4 x M20, M25, 1/2"NPT, 3/4"NPT Weight: 6.5kg

**klaxon**®